

# Overview Map

OV's facilities comprise:

- **Gamle OV** aka **EL0**. The historical center of OV's activities, containing the majority of workshop facilities and components.
- **Nye OV** aka **Center of Excellence**. Features most of OV's computer workstations, **OBS**, the sofa, the **Library** and the **Kitchen**.
- **Mech**, the mechanical workshop, containing most of OV's **Mechanical Tools**.
- **Smia**, a technical room reserved for heavy/fancy equipment. Contains the **laser cutter** and OV's **Vacuum Laboratory**. Normally closed to the public, but access to the equipment can normally be obtained by contacting **OV-Styret**.
- **???** aka the hallway. Contains a wardrobe, the **project storage boxes** and the chemical storage closet.
- **Grovmech**, a storage room for components and materials. Was at one point used for mechanical work.
- **Brus** is a storage- and server room. Storage for OBS, and for OV's IT infrastructure.

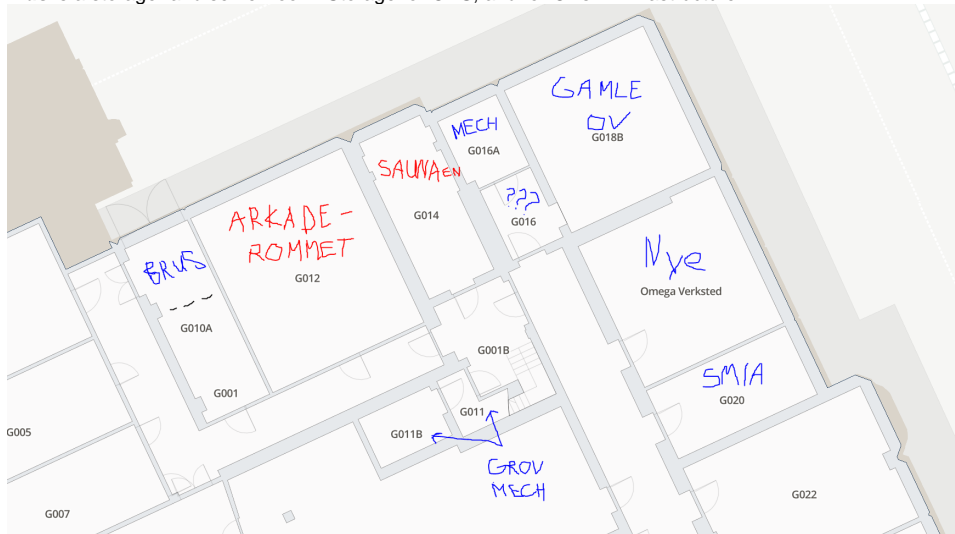

Source: <https://use.mazemap.com/#v=1&zlevel=-1&left=10.4013894&right=10.4022775&top=63.4186667&bottom=63.4184413&campusid=1>